

**PATIENT INFORMATION LEAFLET**  
**OLOPATADINE HYDROCHLORIDE OPHTHALMIC SOLUTION USP 0.2% w/v**  
**(RAPIDONE)**



Read all of this leaflet carefully before you start using this medicine because it contains important information for you.

- Keep this leaflet. You may need to read it again.
- If you have any further questions, ask your doctor or pharmacist.
- This medicine has been prescribed for you only. Do not pass it on to others. It may harm them, even if their signs of illness are the same as yours.
- If you get any side effects, talk to your doctor or pharmacist. This includes any possible side effects not listed in this leaflet. See section 4.

**WHAT IS IN THIS LEAFLET**

- What RAPIDONE is and what it is used for
- What you need to know before you use RAPIDONE
- How to use RAPIDONE
- Possible Side Effects
- How to store RAPIDONE
- Contents of the pack and other information

**1. WHAT RAPIDONE IS AND WHAT IT IS USED FOR**

Olopatadine is used for the treatment of signs and symptoms of seasonal allergic conjunctivitis.

Allergic conjunctivitis. Some materials (allergens) like pollens, house dust or animal fur may cause allergic reactions resulting in itching, redness as well as swelling of the surface of your eye.

Olopatadine is a medicine for treatment of allergic conditions of the eye. It works by reducing the intensity of the allergic reaction.

**2. WHAT YOU NEED TO KNOW BEFORE YOU USE RAPIDONE**

***Do not use Olopatadine***

- If you are allergic (hypersensitive) to olopatadine or any of the other ingredients of this medicine
- You should not use Olopatadine if you are breast-feeding.

***Warnings and precautions***

Talk to your doctor or pharmacist before using Olopatadine.

You should remove contact lenses that are in your eyes before using Olopatadine. Children

- Do not use Olopatadine in children under the age of 3 years. Do not give this medicine to children under the ages of 3 years because there is no data to indicate that it is safe and work in children under 3 years.

***Other medicines and Olopatadine***

Tell your doctor or pharmacist if you are taking, have recently taken or might take any other medicines.

If you are using other eye drops or eye ointment medicines, leave at least 5 minutes between each medicine. Eye ointments should be administered last.

***Pregnancy, breast-feeding and fertility***

If you are pregnant or breast-feeding, think you may be pregnant or are planning to have a baby, ask your doctor or pharmacist for advice before using this medicine.

You should not use Olopatadine if you are breastfeeding, ask your doctor for advice before using this medicine.

### ***Driving and using machines***

You may find that your vision is blurred for a time just after you use Olopatadine. Do not drive or use machines until this has worn off.

Olopatadine contains Benzalkonium chloride:

Benzalkonium chloride may cause eye irritation and is known to discolour soft contact lenses, therefore contact with soft contact lenses should be avoided. If you wear contact lens you should remove contact lenses prior to application and wait at least 15 minutes before putting your lenses back in.

### **3. HOW TO USE RAPIDONE**

Always use this medicine exactly as your doctor or pharmacist has told you. Check with your doctor or pharmacist if you are not sure.

The recommended dose is one drop in the eye or eyes, twice a day – morning and evening.

Use this much unless your doctor tells you to do differently. Only use Olopatadine in both eyes

If your doctor told you to. Use it for as long as your doctor told you to.

Olopatadine should only be used as an eye drop.

- Get the Olopatadine bottle and a mirror.
- Wash your hands.
- Take the bottle and twist off the cap.
- After cap is removed, if the tamper evident snap collar is loose, remove before using the product.
- Hold the bottle, pointing down, between your thumb and middle finger.
- Tilt your head back. Pull down your eyelid with a clean finger, until there is a ‘pocket’ between the eyelid and your eye. The drop will go in here (picture 1).
- Bring the bottle tip close to the eye. Use the mirror if it helps.
- Don’t touch your eye or eyelid, surrounding areas or other surfaces with the dropper.

It could infect the drops left in the bottle.

- Gently press on the base of the bottle to release one drop of Olopatadine at a time.
- Don’t squeeze the bottle; it is designed so that just a gentle press on the bottom is needed (picture 2).
- If you use drops in both eyes, repeat the steps for your other eye.
- Put the bottle cap back on firmly immediately after use.

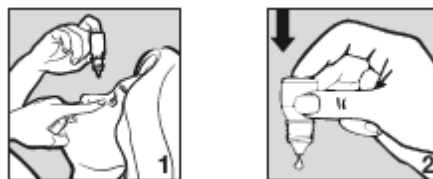

If a drop misses your eye, try again.

#### ***If you use more Olopatadine than you should***

Rinse it all out with warm water. Do not put in any more drops until it’s time for your next regular dose.

#### ***If you forget to use Olopatadine***

Use a single drop as soon as you remember, and then go back to your regular dosing routine. However, if it is almost time for your next dose, skip the missed dose before going back to your regular dosing routine. Do not use a double dose to make up for the one missed.

#### ***If you stop using Olopatadine***

Do not stop using this medicine without first speaking to your doctor. If you have any further questions on the use of this medicine, ask your doctor or pharmacist.

#### **4. POSSIBLE SIDE EFFECTS**

Like all medicines, this medicine can cause side effects, although not everybody gets them.

The following side effects have been seen with Olopatadine

Common: may affect up to

1 in 10 people

Effects in the eye: eye pain, eye irritation, dry eye, abnormal eye sensation, eye discomfort

General side effects: headache, fatigue, dry nose, bad taste

Uncommon: may affect up to 1 in 100 people

Effects in the eye : blurred, reduced, or abnormal vision, corneal disorder, eye surface inflammation with or without surface damage, inflammation or infection of the conjunctiva, eye discharge, sensitivity to light, increased tear production, itchy eye, redness of the eye, eyelid abnormality, itching, redness, swelling, or crusting of the eyelid.

General side effects: abnormal or decreased sensation, dizziness, runny nose, dry skin, skin inflammation.

Not known: frequency cannot be estimated from the available data

Effects in the eye: eye swelling, corneal swelling, change in pupil size

General side effects: shortness of breath, increased allergic symptoms, facial swelling, drowsiness, generalized weakness, nausea, vomiting, sinus infection, skin redness and itching.

In very rare cases, some patients with severe damage to the clear layer at the front of the eye (the cornea) have developed cloudy patches on the cornea due to calcium build-up during treatment.

#### **5. HOW TO STORE RAPIDONE**

Keep this medicine out of the sight and reach of children.

Do not use this medicine after the expiry date which is stated on the bottle and the box after 'Exp'. The expiry date refers to the last day of the month.

Store below 30°C. Protect from light. Keep out of reach of children.

You should throw away the bottle four weeks after you first opened it to prevent infections, and use a new bottle.

Write down the date you opened it in the space on each bottle label and box.

Do not throw away medicines via waste water or household waste. Ask your pharmacist how to throw away medicines you no longer use. These measures will help protect the environment.

#### **6. CONTENTS OF THE PACK AND OTHER INFORMATION**

***What RAPIDONE contains,***

Active ingredients: Olopatadine Hydrochloride

In active ingredients: Benzalkonium Chloride Solution, Diabetic sodium phosphate anhydrous, Sodium chloride, Edetate disodium, Povidone K 30, Sodium hydroxide, Hydrochloric acid

***What RAPIDONE looks like and contents of the pack,***

Clear, colorless solution practically free from particles.

2.5 ml in 5 ml 3-Piece container in a single carton.

#### **Manufacturer**

**MICRO LABS LIMITED**

Plot No. 113-116, Phase IV, KIADB Industrial Area

Bommasandara

Bangalore 560 099

INDIA

**Marketing Authorisation Holder**

MICRO LABS LIMITED  
31, Race Course Road  
Bangalore-560001  
INDIA

**Marketing Authorization Number**

0780/Rwanda FDA/2019

**Date of Revision**

July 2021